

Mounting the L-shaped aluminium mounting bracket

SOG® + SOG® II type A+B

for Thetford C2, C3, C4 and C200

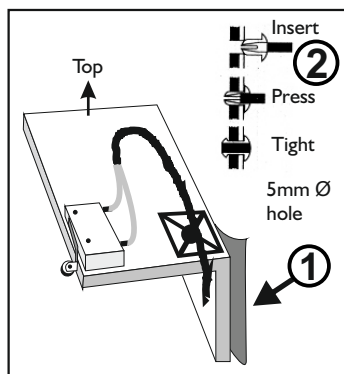

Mounting the L-shaped aluminium mounting bracket:

Before sticking, clean the mounting surface on the sheet metal wall with methylated spirit.

The bracket surface with the adhesive film must be fixed pointing downwards.

The aluminium L-bracket is mounted with the adhesive surface vertical and must be so placed that the roller on the microswitch ③, is pressed in on the back edge of the closed blade valve mechanism.

When the correct position has been found, remove the protective foil ①, from the adhesive surface of the L-shaped mounting bracket to mount it.

Reinforce with the expanding rivet ②. Bore a 5 mm hole from the service space side and push the rivet ② in from the washroom side and press in the rod.

NOTE: When the switch is pressed the current is interrupted so that the ventilator only runs when the blade valve is open.

