



Remove overpressure valve from the cartridge.



Insert SOG hose connection into the bayonet and turn right until you feel the hose connection click into place.



If there is already a hole for the control magnet in the slide handle, the magnet will be inserted here.



First push the control magnet with the face marked black into the hole so that it closes flat with the outer side of the slide handle.

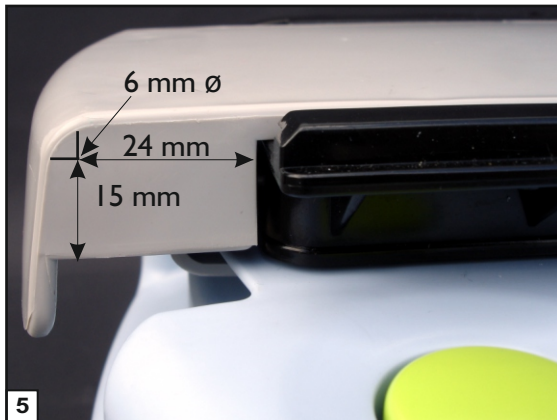

If there is not a hole in the slide handle on the ventilating knob side of the cartridge, this must be provided subsequently.  
Follow the dimensions according to the photo.



Unlock slide handle and pull on, locate cartridge in reverse position and unscrew the four Torx screws with Torx insert TX 10. Remove slide handle.

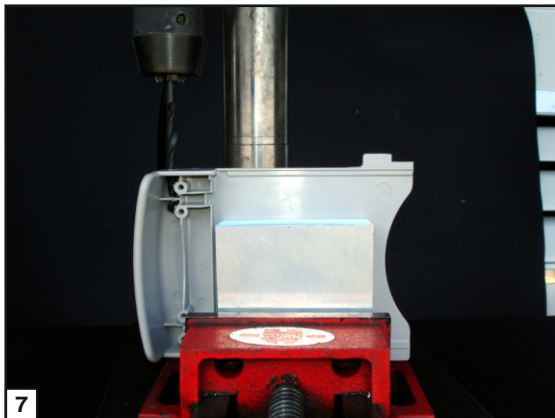

Clamp slide handle in machine vise (see photo).  
Pre-drill hole with 3 mm drill and then fully drill with 6 mm drill.  
Attention: drill both holes at high speed and low rate of feed.

blank side  
→

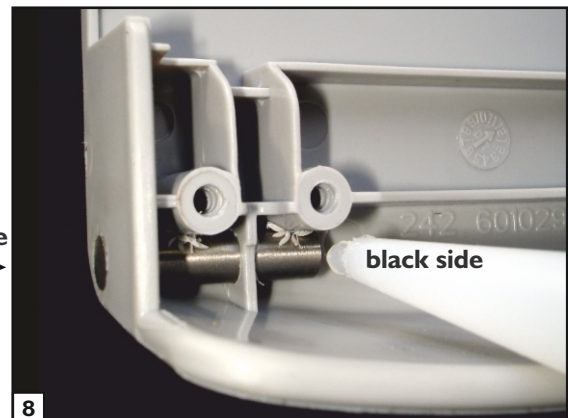

First push control magnet with the face marked black into the hole (direction of the arrow) until this closes with the outer side of the slide handle (black side).  
Fasten the control magnet with silicone.  
Insert slide handle into the guide rails again and screw in.