



Rubber | Isolation | Fibreglass

Product Information

Safety Edges

made of EPDM

Protection Category IP68/ IP69k

Tested in dependence on EN 1760-2: 2001 + A1: 2009



Gummi-Welz GmbH & Co. KG
Otto-Renner-Str. 28
89231 Neu-Ulm
Germany

Tel. +49 731-93609-0
Fax. +49 731-93609-90

info@gummi-welz.de
www.gummi-welz.de

Your Advantages:

- Homogeneously made of EPDM (halogen-free)
- High quality, vulcanized, plane tangential gating
- Application area of temperature: -40°C/+100°C
- Protection category (tightness): IP 68/ IP 69K according to EN 60529
- Fire protection: Possible to Railway standards
- Standard resistor: 1,2 K Ω / 8,2 K Ω / 850 Ω / no
- Minimal inoperative border areas
- Combined with special designed “Finger protection profiles” achieves high sensitivity main closing edges for door systems in trams, busses and special vehicles develop
- Usage of similar material in finger protection profile and safety edge, thereby no mutual chemical interaction
- Maintenance-free, self-monitoring by the use of closed-circuit principle
- Reliable function, regardless of temperature differences (compared to air pressure detection systems)
- Reduction of maintenance costs compared to air pressure detection systems
- High elasticity and ageing resistance
- Stable to many chemical products

From one source:

- Receiving “Finger Protection Profiles” with “Safety Edges” from one source, secures the best possible safety and switching function

Switch Design:

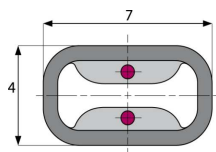

Switch 7 x 4

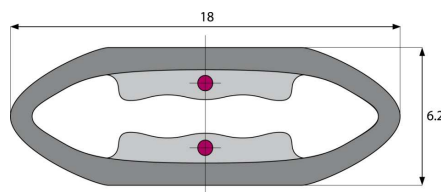

Switch 18 x 6, 2

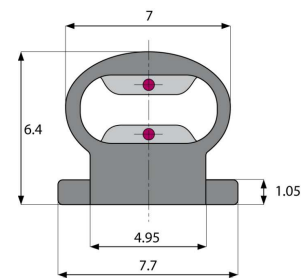

Switch 7, 7 x 6,4

Tested by:

TÜV Nord

Specific values in dependence on EN 1760-2: 2001 +A1: 2009: Safety of machinery, pressure-sensitive protection device Part 2: Safety edges/ Safety rods